

Cross roller bearings

RA-RA12008

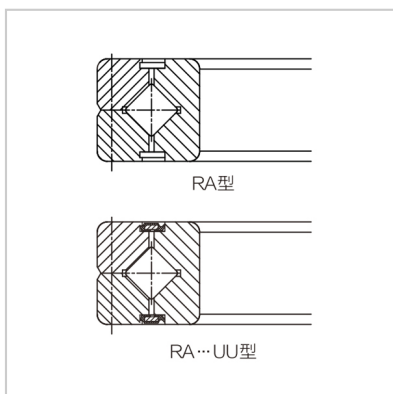
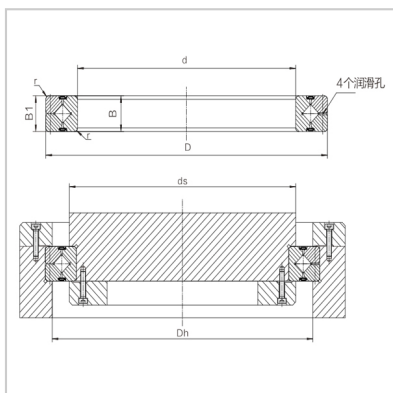

Nominal model : RA12008

Main dimensions (mm) :

d : 120

D : 136

B : 8

Roller pitch diameter
 Dpw : 127

Chamfered r min : 0.5

Shoulder size (mm) :

ds : 123.5

Dh : 130.5

Basic rated load (radial) :

C_r kN : 7.84

C_{0r} kN : 16.5

Weight :

K_g : 0.17

: